



Easy-action  
Door Closer

# DORMA TS 83



## The multi-function, multi-purpose door closer

### Outstanding versatility. Quality assured.

#### Tested to EN 1154.

Decades of experience have gone into the development of the DORMA TS 83. The result is user comfort coupled with outstanding versatility. It can be adjusted to suit almost all types of door. Additional anti-corrosion protection for exposed or aggressive conditions is available to special order.

Fixing couldn't be easier and last but not least – it's engineered for excellence.



Quality-assured manufacture to ISO 9001, EN 29001, BS 5750. Certified and verified by BSI Quality Assurance Reg. No. Q 6423, FM 10756

### Plus points ...

#### ... for the trade

- Streamlined product range means low inventory costs and reduced stocking requirement.
- Comprehensive choice of accessories provides practical and effective solutions to meet special applications.

#### ... for the specifier/architect

- Compact closer design and sturdy flat-form arm assembly.
- Wide range of standard functions supplemented by optional extras.
- Suitable for fire doors. (CERTIFIRE approved ITT Ref. CF 118)

#### ... for the installer

- Easy to fix.
- Can be "tailored" to the requirements of the door by simple adjustment.
- Just one model for RH (ISO 5) and LH (ISO 6) doors and for standard and frame/lintel fixing and parallel arm.
- Spring strength range EN 2-6 to suit virtually every application.

#### ... for the user

- Optimum wall and door protection thanks to "thinking" backcheck.
- Closing speed virtually unaffected by temperature fluctuations.
- High mechanical efficiency gives easy-action opening.

### Applications and fixing ...

#### ... on the pull side

Door leaf fixing (standard installation)

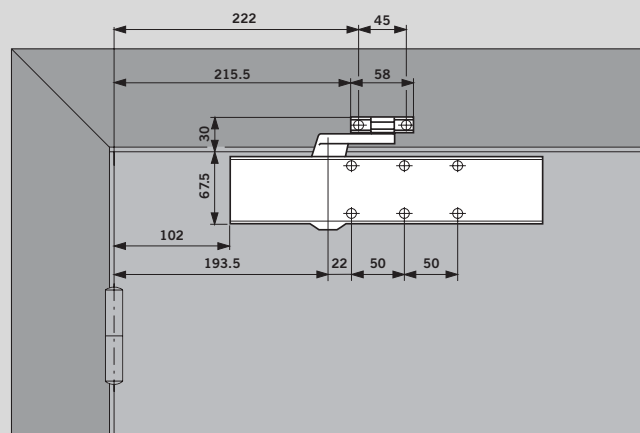
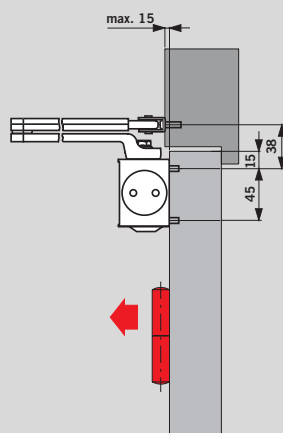

#### ... on the push side

Door leaf fixing (parallel arm installation)  
With parallel arm application, the backcheck comes in later at between 85° and 90°, depending on the door thickness and projection of the hinge used; the delayed action, on the other hand, releases the door at an earlier point in its closing sweep.

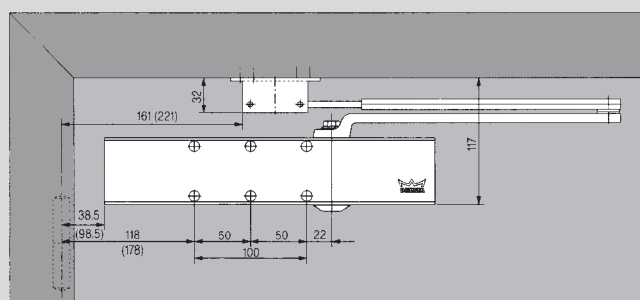
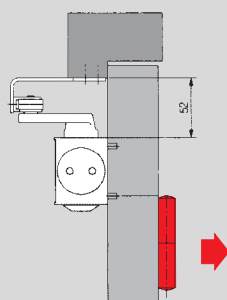

#### Examples

Installation for the opposite hand is a mirror image of the above illustrations.

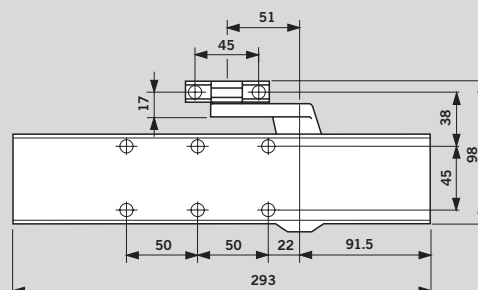
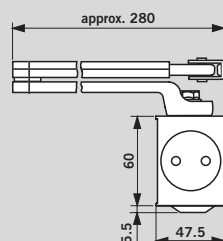

The TS 83 conforms to most recognised international standards and complies with the requirements and/or recommendations of the following: CERTIFIRE approved for fire doors ITT; Ref. CF 118  
Closer weight: 3.3 kg

## Standard functions

### With “thinking” backcheck –

Thanks to an innovative design concept, the resistance developed by this backcheck system is directly proportional to door acceleration as the door is opened beyond approx. 70°. It is almost imperceptible when the door is opened slowly. However, if the door is opened roughly, the backcheck responds in equal measure.

And if the door should be flung open at speed – whether deliberately, thoughtlessly, accidentally or as a result of a gust of wind – the backcheck reacts at full strength, protecting the wall and door from damage.

**If no backcheck function is required, the system can simply be switched off.**

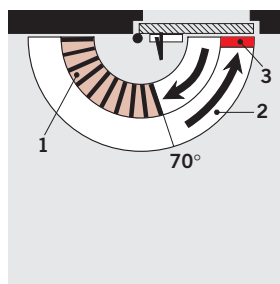

- 1 Self-adjusting backcheck
- 2 Fully controlled closing with adjustable speed
- 3 Adjustable latch range

### And with delayed action –

The integrated delayed action enables the closing cycle to be retarded within an adjustable range so that

disabled persons, mothers with prams and people carrying bulky items are able to pass through the door without difficulty.

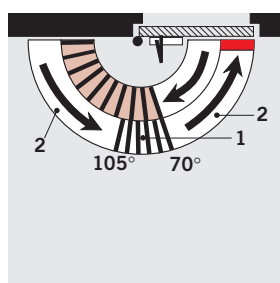
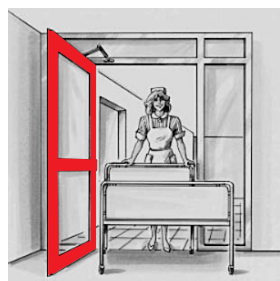

- 1 Adjustable delayed action
- 2 Fully controlled closing with adjustable speed

### With optional hold-open arm –

Combining the TS 83 with a hold-open arm enables the door to be held open at an appropriate angle (up to

approx. 150°). The hold-open function of the standard hold-open arm can be switched on and off by the user by simply pressing a pushbutton.

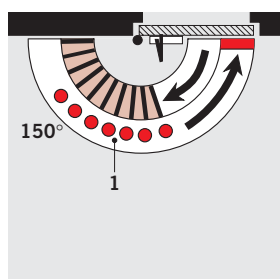

- 1 Hold-open range

**Hold-open arms are not approved for fire doors.**

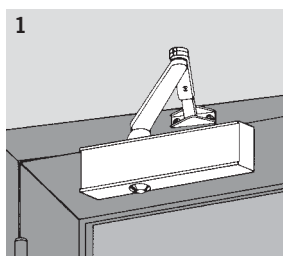

**Standard installation**  
Art. No. 8300

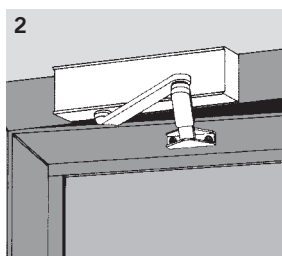

**Frame installation**  
Art. No. 8300

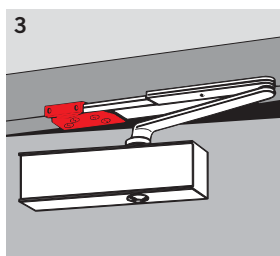

**Parallel arm installation**  
Art. No. 8300  
(The above bracket is supplied with every TS 83 standard door closer.)

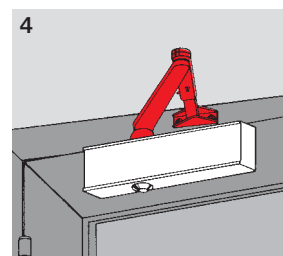

**Hold-open arm installation**  
Art. No. 8301  
Adjustable for hold-open up to 150°. Can be switched off to act as a standard arm.

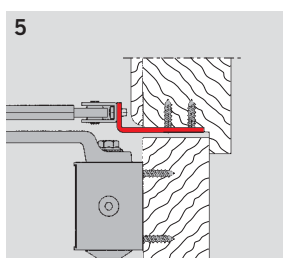

**Soffit bracket and arm for standard installation with shaped architrave**  
Art. No. 8382/1

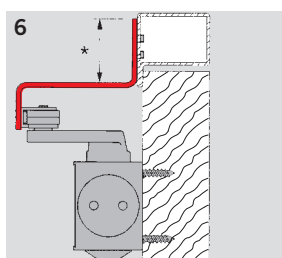

**Parallel arm bracket with upstand**  
(\*upstand 35 or 60 mm)  
Art. No. 8382/2

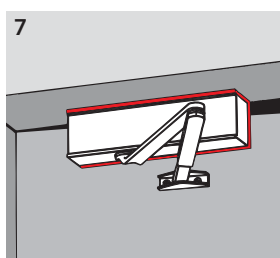

**Angle bracket installation**  
Frame installation for outward opening doors with extra deep reveals.  
Art. No. 8357

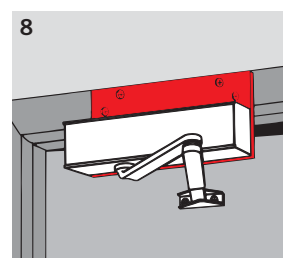

**Drop plate installation**  
For installation on frame (or door) when direct fixing of closer is not possible.  
Art. No. 8359

#### Specification text

DORMA TS 83 rack and pinion door closer; non-handed; hydraulic control from 180°; adjustable spring strength EN 2–6; separate sweep and latch valve; self-adjusting backcheck and adjustable delayed action. Suitable for standard or frame installation on doors up to 1400 mm wide.

Parallel arm installation suitable for doors up to 1200 mm wide.

Specify finish: silver, dark bronze, gold lacquer. A range of colours is also available.

For architectural electro-plated finishes see separate brochure.

**DORMA Door Controls Ltd.**  
DORMA Trading Park  
Staffa Road  
GB-London E10 7QX  
Tel. 020 8558 8411  
Fax 020 8558 6122  
E-mail:  
hardware@dorma-uk.co.uk

**DORMA Door Controls Ltd.**  
19, Sandyford Office Park  
Foxrock  
IRL-Dublin 18  
Tel. 01 295 82 80-82  
Fax 01 295 85 84  
E-mail:  
dormadublin@dorma.com

**DORMA GmbH + Co. KG**  
P.O. Box 40 09  
D-58247 Ennepetal  
Breckerfelder Str. 42-48  
D-58256 Ennepetal  
Germany  
Tel. +49(0)23 33/7 93-0  
Fax +49(0)23 33/79 34 95  
www.dorma.com